

BUILDING CONSENT

GRANTED
4/12/2020

HUTT CITY COUNCIL

HUTT CITY
12 RMA Kaitiaki

Plumbing & Drainage Notes

General plumbing notes
Contractor to ensure all work complies with the NZ Building Code and relevant standards, along with local territorial authorities' bylaws prior to work commencing.
All Foul Water plumbing work to comply with AS/NZS3500.2
All Storm Water plumbing work to comply with E1/AS1 & AS/NZS3500.3
All bends and junctions under slab must not be less than 45° (in plan).
Contractor/Plumber to submit as laid drainage plan to council upon completion of all plumbing/drainage works

Water supply
Water supply pipe materials to comply with G12/AS1 table 1:
Hot & Cold: copper, galvanised steel or polybutylene
Cold only: uPVC or polyethylene
All hot and cold water pipework through slab shall be in DN65 uPVC conduit.
All hot water piping shall be thermally insulated to comply with H1/AS1 clause 5.0 hot water

systems

All water supply pipe sizes installed to comply with G12/AS1 table 4
Sink, laundry, bath, basin 15mmØ
Shower 20mmØ
Pipes based on a maximum pipe length of 20 metres

Ensure hot water temperature at any sanitary fixture used for personal hygiene does not exceed 55°

Fixture trap and waste sizes
Fixture traps for hand basins to be DN40 trap, DN65 drain pipe
Fixture traps from sinks, bath, showers and tubs to be DN65 trap, DN65 drain.
Fixture traps from WC to be DN100 trap and DN100 drain.

Continuous spouting rainwater system
Continuous spouting rainwater system, prefabricated Colorcote spouting and downpipes, DN80 downpipes unless otherwise noted.

Hot water cylinder
180L HJ Cooper electric hot water cylinder. Installed to manufacturers specification. HWC to be installed

over safe tray. Relief valve drains to be of copper pipe, have no restrictions or valves, have a continuous fall from the relief valve to the outlet, discharged in a visible position which does not present a hazard or damage to other building elements.

Proprietary acrylic shower
Proprietary acrylic showers to be installed in accordance with E3 internal moisture. Acrylic wall linings shall extend to ceiling. Junctions used between the tray and wall linings shall be constructed in accordance with E3 Figure 4 (a) or (b) Refer details. All glazing within a wet area to be grade A safety glass.

Overflow Relief Gully
Overflow relief gully to be installed so that the top of the overflow gully riser is at a height of min. 150mm below the lowest fixture, and min. 75mm above the finished ground level and the overflow level of the gully dish will be no less than 25mm above paved surfaces and will have a grating that will allow surcharge. Waste pipes that discharge to the gully trap are arranged to permit easy cleaning of the gully trap.

3.6.6 Separation from other underground services
The separation between any underground drain and any other service other than consumer gas piping, electrical communication service or water service shall be at least 100 mm or 300 mm from a stormwater drain exceeding DN 100 (see Figure 3.3).

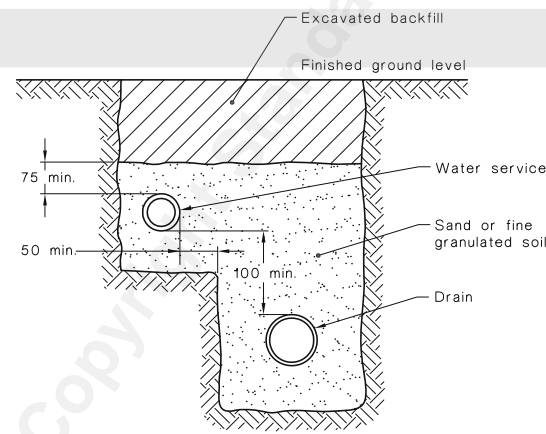
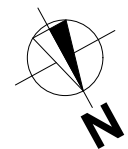

FIGURE 3.3 TYPICAL SHARED TRENCH

Plumbing Legend

- dp DN80 downpipe
- org Overflow relief gully
- TV DN50 terminal vent
- IP Inspection point
- aav Air admittance valve
- HWC 180L Hot water cylinder



FRIDAY HOMES (04) 595 1287
www.fridayhomes.co.nz

Head office: 6-8 Meachen Street, Seaview. PO Box 30389, Lower Hutt
© Copyright Kakariki IP Limited 2016 trading as Friday Homes

COPYRIGHT RETAINED BY DMAC HOMES LTD.
CONTACT IMMEDIATELY IF AN ERROR OR DISCREPANCY IS DISCOVERED

D6-G - Tekapo 2
Lot 14, Stage 1
Manapouri Grove, Kelson, Lower Hutt

Plumbing Plan

ISSUE DATE: 1/12/2020	REV. DATE:	SHEET NO. 108r1
REF: 19092		
SCALES (A3): 1:100, 1:1.6268		CODE:

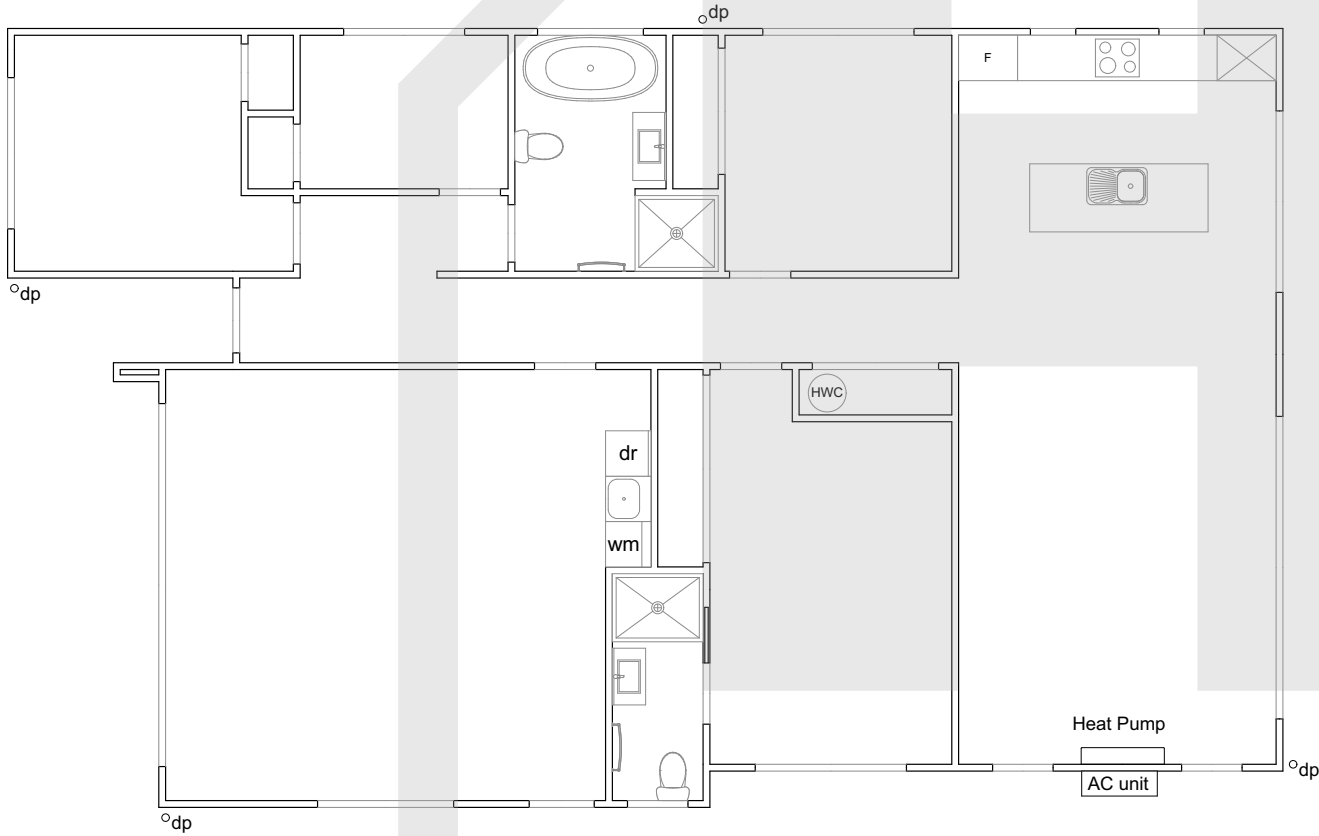
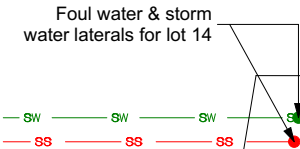

BUILDING CONSENT

GRANTED
4/12/2020

HUTT CITY COUNCIL



REVISED
12/03/2020
HUTT CITY COUNCIL





(04) 595 1287
www.fridayhomes.co.nz

Head office: 6-8 Meachen Street, Seaview. PO Box 30389, Lower Hutt
© Copyright Kakariki IP Limited 2016 trading as Friday Homes

COPYRIGHT RETAINED BY DMAC HOMES LTD.
CONTACT IMMEDIATELY IF AN ERROR OR DISCREPANCY IS DISCOVERED

D6-G Tekapo 2
Proposed Lots 14, Stage 1
Manapouri Grove, Kelson, Lower Hutt

As - Laid Plumbing Plan

ISSUE DATE:	6/03/2020	REV. DATE:		SHEET NO. 109
REF:	19092,			
SCALES (A3):	1:100	CODE:		