

SERVICES KEY:

- Proposed Pottable Water supplies
- Proposed Grey Water (roof collection)
- Proposed Fire Fighting Water pipes with Hydrants
- SS Proposed Sewer connections
- SW Proposed StormWater connections
- Proposed Power connections
- Proposed Data & Security

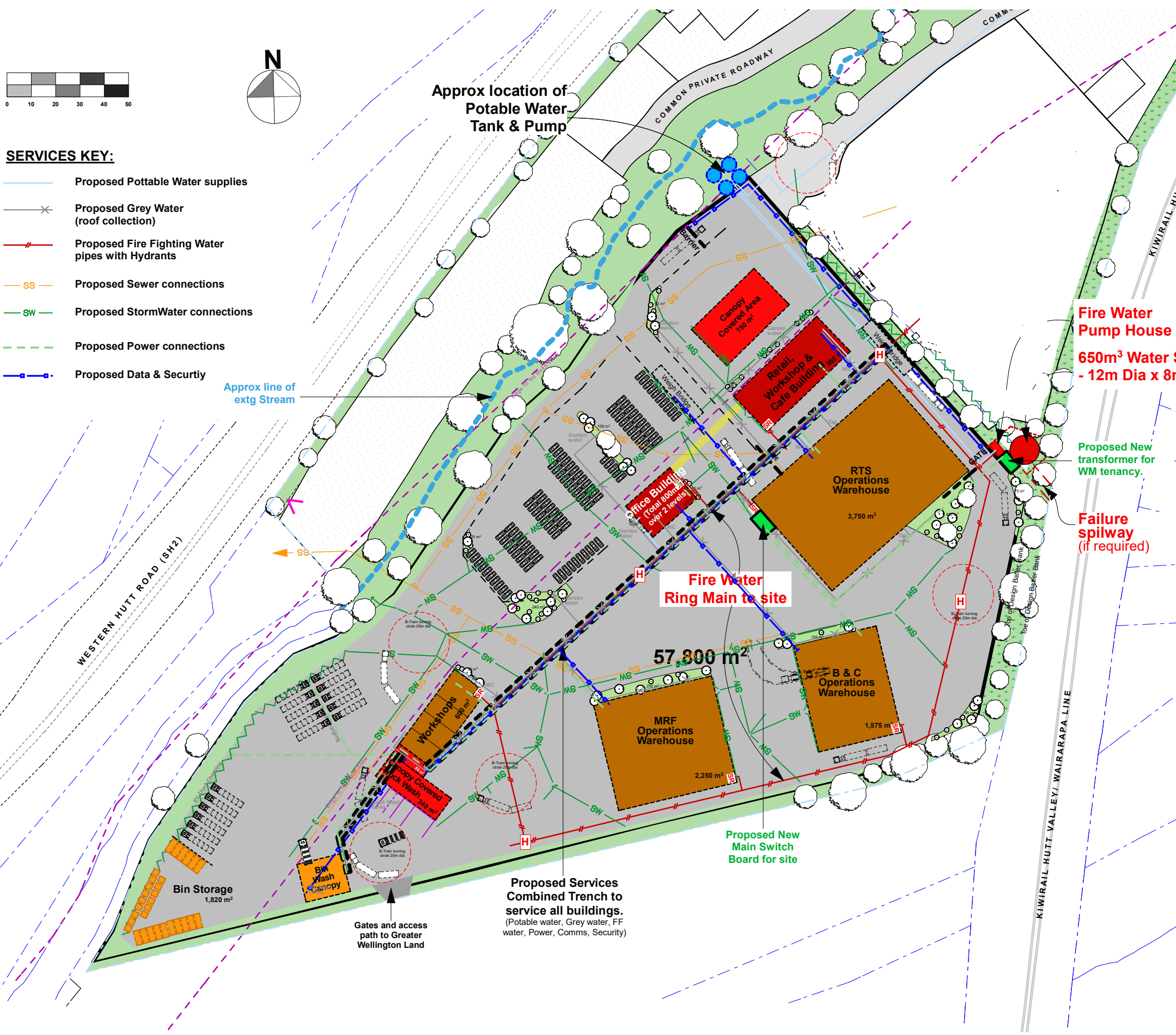

Site Services - WMNZ

Te Kārearea Business Park
Benmore Cres - Manor Park - Hutt City
proposal for
Te Karearea Limited & Te Rūnanga O Toa Rangatira

07 June 2025 Refer Bar Scale 2426



HARRIS
ARCHITECTS
LIMITED
021 110 8895 derek@harch.nz
www.harch.nz

with Proposed SS & SW drains
with Fire Fighting Water
Proposal THREE

Fire Water Pump House
650m³ Water Storage Tank
- 12m Dia x 8m high

Proposed New transformer for WM tenancy.

Failure spillway
(if required)

Fire Water Ring Main to site

Proposed New Main Switch Board for site

Proposed Services Combined Trench to service all buildings.
(Potable water, Grey water, FF water, Power, Comms, Security)

Gates and access path to Greater Wellington Land