

Wainuiomata Spatial Plan – Engagement Results

Background

A streetscape plan for Wainuiomata’s Town Centre was developed based on community feedback collected during the Wainuiomata Development Plan consultation conducted in 2014/15.

The Wainuiomata Development Plan was a collaboration between Love Wainuiomata, Hutt City Council and the wider community. The streetscape plan was guided by principles developed during the consultation.

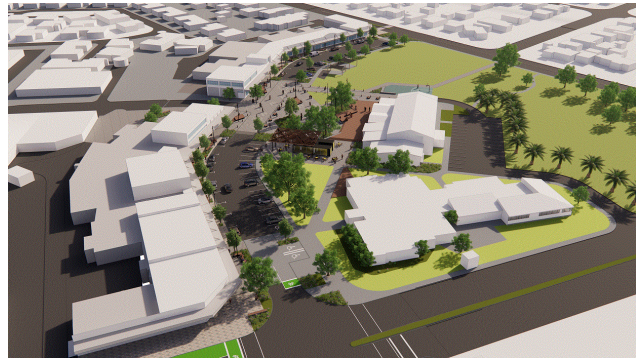

Engagement

Between April 6th and May 6th Council engaged with, and sought feedback from, the Wainuiomata Community. A display was set up in the library with Council officers available to answer questions and take feedback several times a week. A survey was available both online and in paper form. The survey asked for feedback on how the community would use the proposed spaces and what further enhancements could potentially increase their use. An evening workshop was held at the Hub and community meetings were held with the Returned Services Association and Mana Whenua. These were attended by a number of Council Officers. Council also received a number of emails and notes from the community on various aspects of the plan, and one petition regarding car parking.

Feedback

We received over 330 pieces of feedback from the community. The following is a summary of the feedback we received that has informed the design process.

Who we heard from

Most (78%) of the feedback received came from Wainuiomata residents. One in ten (11%) respondents are aged under 30 years and all but one stated they lived in Wainuiomata. Those from outside Wainuiomata were most likely to be aged between 50 and 69 years.

Figure 1: Over three quarters of respondents stated they lived in Wainuiomata

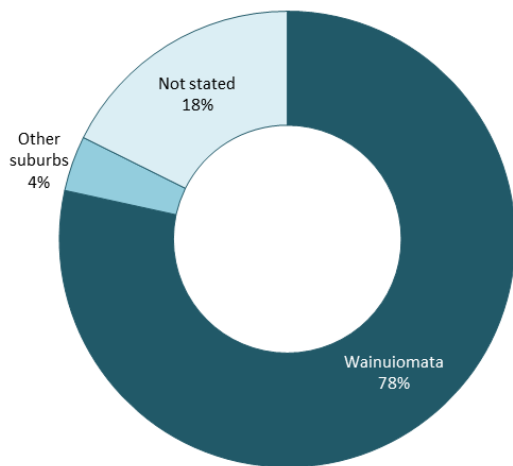

Who we heard from

Most (78%) of the feedback received came from Wainuiomata residents. One in ten (11%) respondents stated they were aged under 30 years and all but one stated they lived in Wainuiomata. Those from outside Wainuiomata were most likely to be aged between 50 and 69 years.

Figure 2: A range of age groups contributed to the feedback informing the next steps

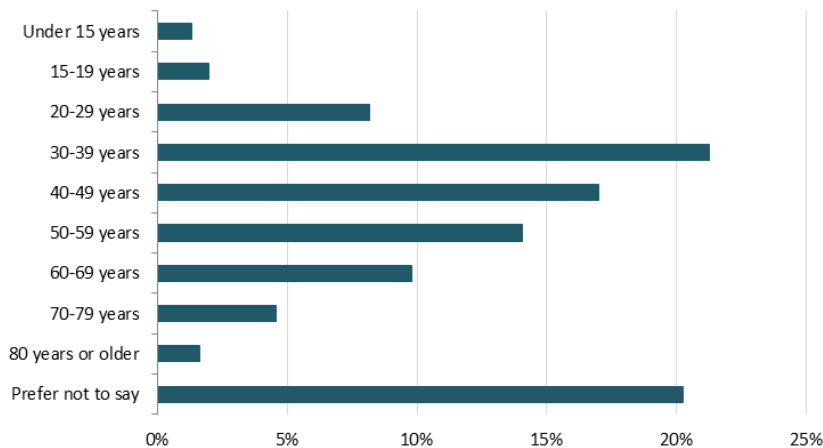

The comments and ideas were grouped by location and age for analysis. Those who did not state where they lived or their age were grouped in 'other'.

The new Civic Heart

Respondents thought they would use the new Civic Heart area to sit, eat, relax and hang out in. Several mentioned they would use the space to meet up with friends and, or family and generally looked like a good space to make community connections.

"Eat lunch and enjoy the space or catch up with friends"

"Enjoy sitting down for lunch. Spend more time in the area when ducking into a local shop."

"From a workday perspective I'd use the space as an opportunity to get out of the office and spend some time outside for lunch etc. I'd love to be able to take clients for a coffee up the road. Personally, I think it would be a great space to take the kids (and future grandkids) for community events and activities."

"Place to meet up with family and friends, have picnic lunches, dinners. Hopefully enjoy any markets, outdoor concerts, fundraisers, local art being promoted."

"Sitting in sun, picnics with friends. Meeting point. ANZAC Day commemorations etc. Path to library and community centre. "

"Meet friends for a coffee and a yap."



When asked what improvements or additions they would like to see to the Civic Heart area the most common response was a playground or something to occupy children. Increased carparking, improved shopping options, increased seating and the addition of a public toilet also came up frequently. Other ideas included drinking fountains, a café, tables, public bbq's, shaded areas and a garden or green area.

- "A little playground area for kids to enjoy, so I can sit down in the nice area and watch the kids also."*
- "Dedicated eating spaces/areas. Picnic tables and BBQ (coin donation) for a family area/space."*
- "Extra park benches, some under shade for our children and elderly people, a drinking fountain so at least people can refill bottles encouraging more water drinking instead of buying fizzy."*
- "I'd like to see a playground in the area for the babies so that we could make better use of the bbq area."*
- "If there was a nice landscaped garden to look at and sit in that would entice me plus well-made seating and paving."*
- "Public toilet / Small children's play area / Drinking fountains"*
- "Parking to provide easy access to shops and services. A good cafe."*
- "Accessibility for seniors and disabled. More disabled parking. An increased number of parking bays as with our growing community and housing intensification the current plan does not allow for the growth within our community and increased volume in traffic."*
- "Keep parking as many as you can."*



Stage Area

Respondents liked the idea of events being held in this space. Outdoor markets, concerts, performances and exhibitions were mentioned frequently. Many mentioned that having such events

A Pavilion

There was a high level of support for a space that could potentially house a café or similar. Respondents were in favour a space that would enable them to meet friends or hang out while doing other errands or entertaining young children. The hosting of community activities and events were also mentioned as a possible use for this space.



- "Would definitely buy food and drink regularly there during fine weather.*
- "I would become a regular visitor to the cafe (if added)"*
- "Would use the small cafe when going to the library."*
- "I would possibly have morning tea with friends there. Currently there isn't anywhere in Wainuiomata to meet friends for a coffee/morning tea/afternoon tea."*
- "A chalk board wall where people can write inspiring quotes."*
- "Community weaving sessions, community dance courses."*
- "Chess, board games, art classes, pottery, history lessons."*
- "Exhibitions about outdoors of Wainui, history of Wainui, flora and fauna of Wainui etc Dedicated food venue/cafe. Fully equipped commercial kitchen could be used as a focal point for demonstrations during markets or event. Market Kitchen?"*

The need for a café was reiterated by respondents when asked what additions to the Pavilion might increase their use of the space. Other suggestions included seating, a public toilet, shelter, Wi-Fi and accessibility.



- "A small café"*
- "Have shelter overhead in case it rains e.g. a glass roof."*
- "Cafe would be great! Preferably with device charging/public power points."*
- "Seating area outside for café"*
- "Rain proof roof. Can be retractable for high winds and power."*
- "I would love there to be a cafe with seating, and if it was any good, I would regularly use it. Having the ability to open up the site with say large windows/awnings".*
- "Perhaps clear PVC "walls" that can roll up or zip out, to enable the area to be used for more of the year."*
- "Ensure that this place is accessible for all people."*
- "So long as there's coffee, some seating and shelter if needed, I'd use it. Bonuses are definitely a public toilet and wifi would be a huge bonus."*