

Queen Street Area Upgrade



Wainuiomata
Memorial Hall

Library

Wainuiomata Road

Fitzherbert Road

Queen Street Area

Parking options

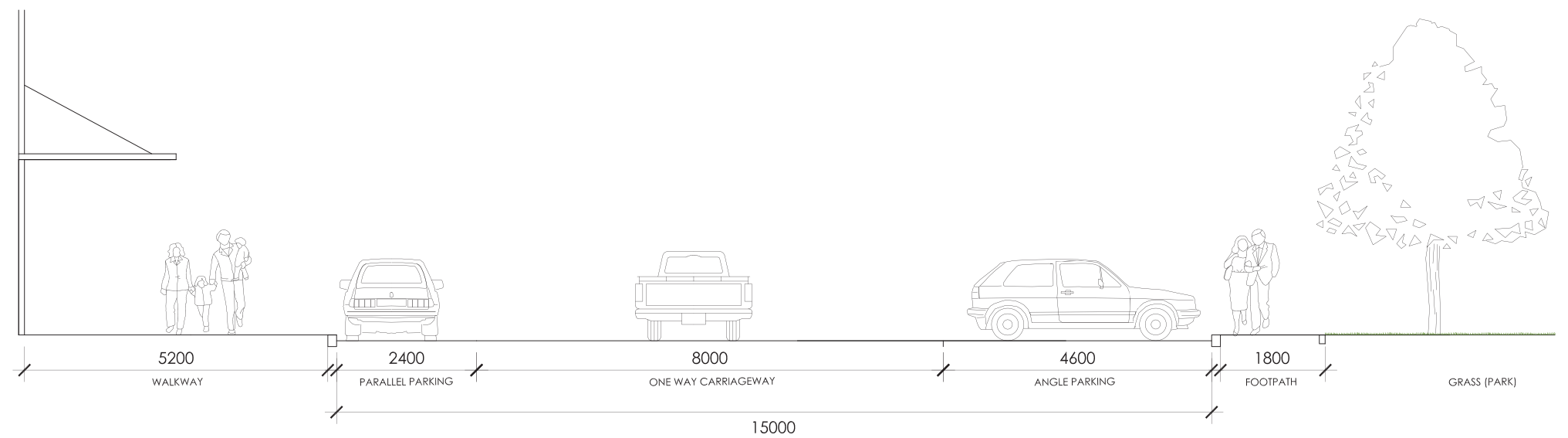
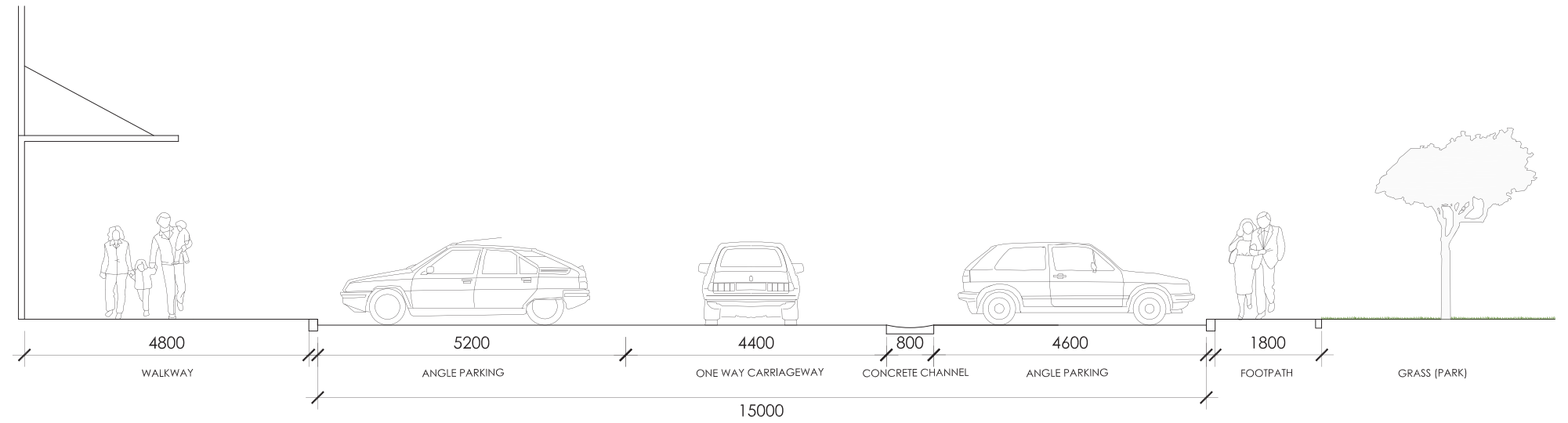



Existing car parks = 85

Existing car parks = 11

Existing car parks = 32

Total = 128

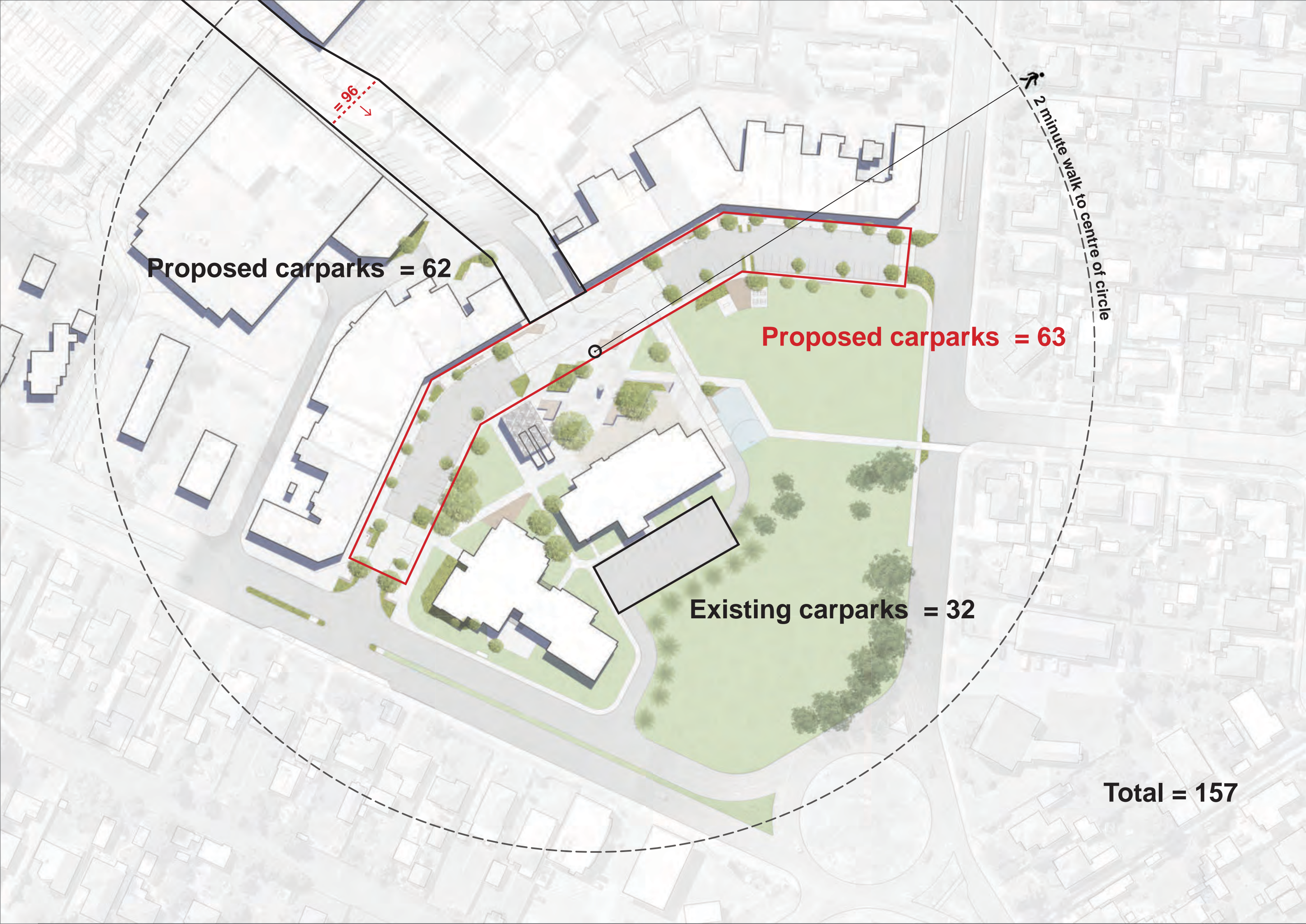

Proposed carpark = 62

Proposed carpark = 63

Existing carpark = 32

Total = 157

96

2 minute walk to centre of circle

View 1



View 2



View 3



View 4



View 5



View 6



View 7



View 8



View 9



View 10



View 11



View 12



View 13



View 14





Area 1A:	620m2	\$720K
	\$600k if concrete	
Area 1B:	560m2	\$740K
	\$590k if concrete	
Area 1C:	3000m2	\$3.740m
	\$3m if concrete	
Sub Total		\$5.2m
	\$4.550m if concrete	
Area 2A:		\$575k
	1320 m2 @ \$400 per m2	
Area 2B:		\$595k
	1375m2 @ \$400 per m2	
Area 3A:		\$1.100m
	1450m2 @ \$700 per m2	
Area 3B:		\$390k
	525m2 @ \$700 per m2	
Area 4A,B,C:		\$ TBC
Pavillion:		\$430k
Total:		\$8.290m

Costs include fees and 15% contingency

Outline Budgets

Pavillion



Materials

PAVING

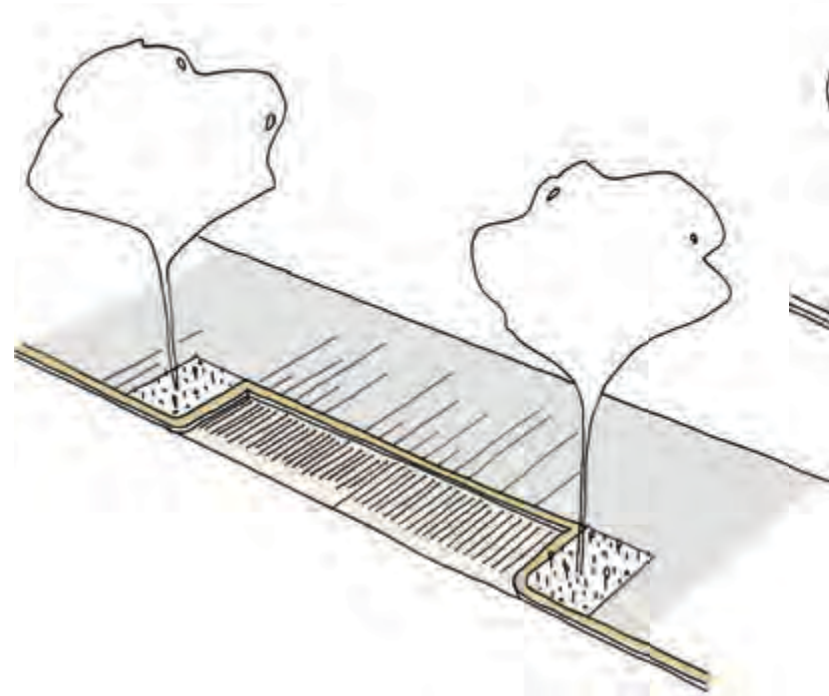

SOCIAL INFRASTRUCTURE

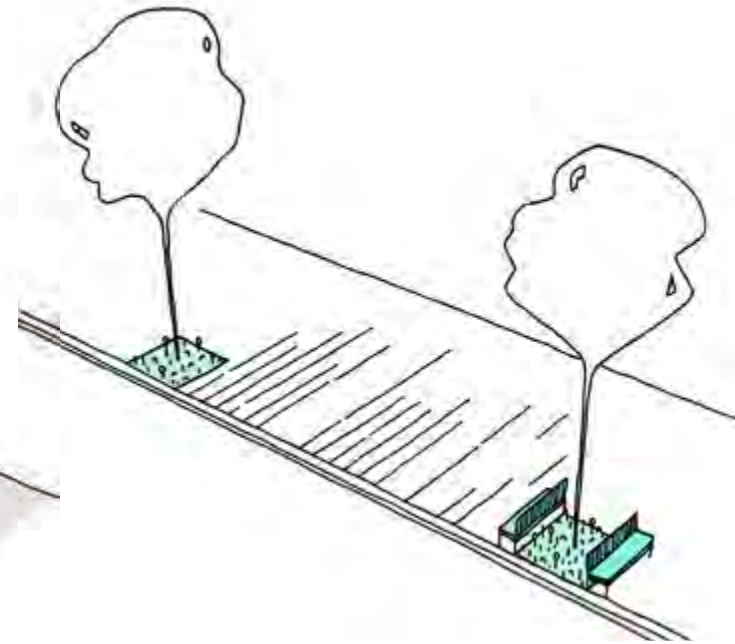

RETAIL SPILLOUT

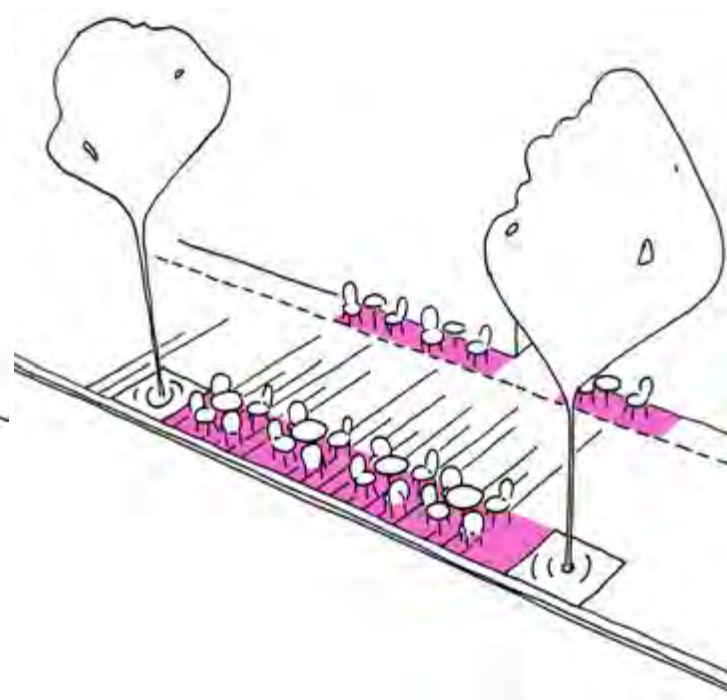

STORMWATER MANAGEMENT

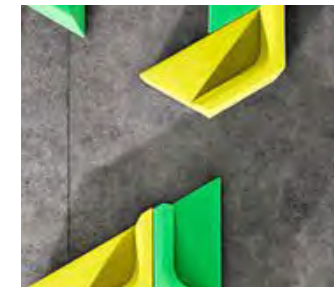
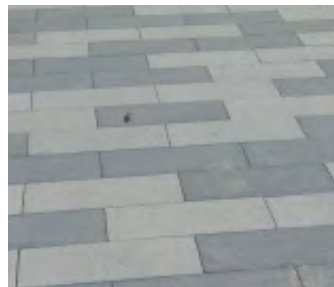
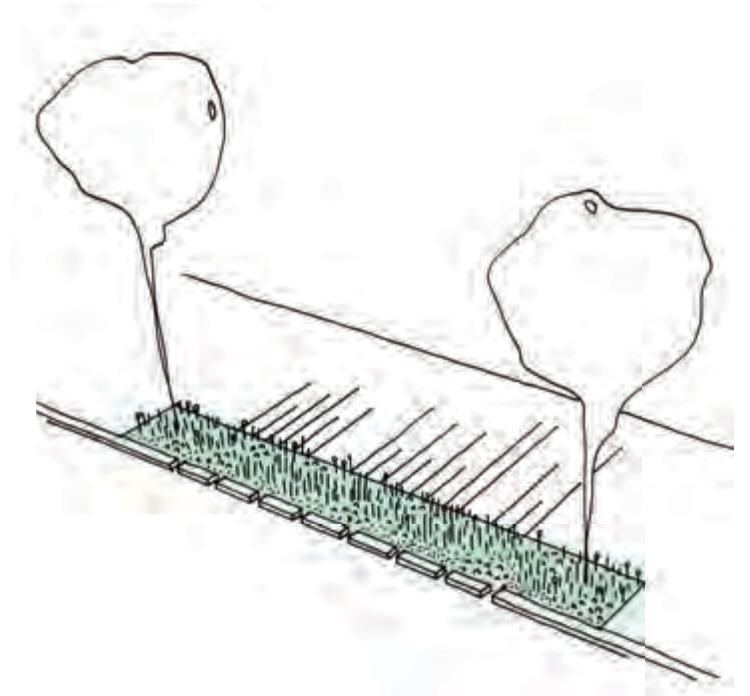

Stage 1



Wainuiomata
Memorial Hall

Library

Wainuiomata Road

Fitzherbert Road

Stage 2



Wainuiomata Road

Fitzherbert Road

Library

Wainuiomata Memorial Hall



Wainuiomata Memorial Hall

Library

Wainuiomata Road

Fitzherbert Road